

**RC - RCS - RCQ - SYSTEMA**

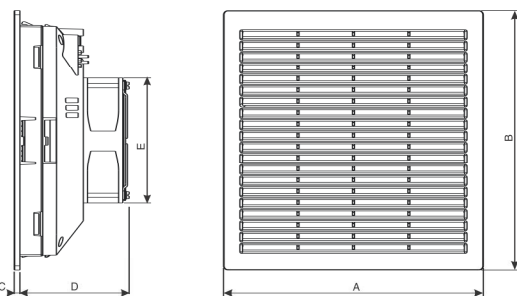

Model	A	B	C	D	E
<b>RCQ 160.25</b>	250	250	6	105	120
<b>RCQ 370.25</b>	250	250	6	118	152x172

9

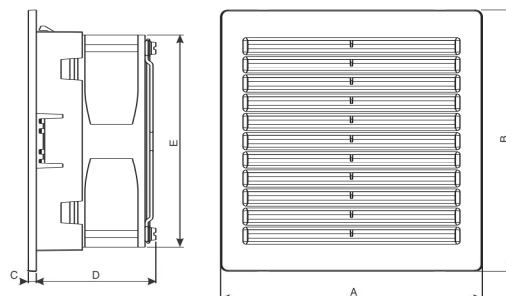

Model	A	B	C	D	E
<b>RCQ 50.11</b>	110	110	4,5	61	80
<b>RCQ 160.15</b>	148	148	5	68	120

10

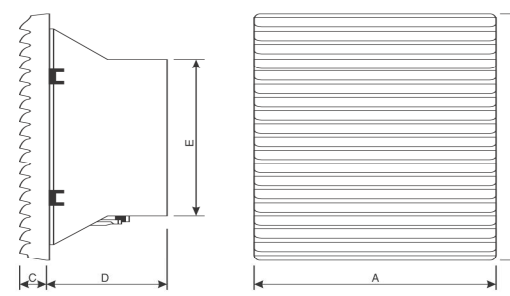

Model	A	B	C	D	ø E	Kg
<b>RC 10.13</b>	130	140	24	74	98	0,6
<b>RC 12.13</b>	130	140	24	74	114	0,6
<b>RC 14.25</b>	256	256	29	91	147	1,2
<b>RC 14.32</b>	323	322	34	145	147	1,6
<b>RC 15.32</b>	323	322	34	145	147	2,6
<b>RC 20.32</b>	323	322	34	140	204	3

11

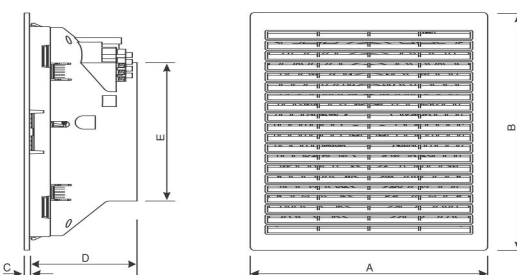

Model	A	B	C	D	ø E	Kg
<b>RC 12.15 S</b>	148	148	4,5	67	120	0,6
<b>RC 14.25 S</b>	250	250	5,5	113	147	1,1
<b>RC 20.32 S</b>	318,5	318,5	5,5	160	204	3

12

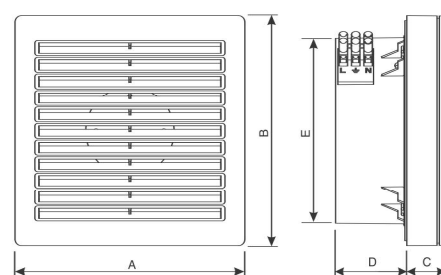

Model	A	B	C	D	ø E	Kg
<b>RC 12.15 S + D 15 S</b>	148	148	25,5	46	120	0,7

13

Model	dB(A)2m
RC 10.13	38
RC 12.13	38
RC 14.25	40
RC 14.32	39
RC 20.32	55
RC 12.15 S	36
RC 14.25 S	40
RC 20.32 S	55
RCQ 50.11	32
RCQ 160.15	40
RCQ 160.25	39
RCQ 370.25	50

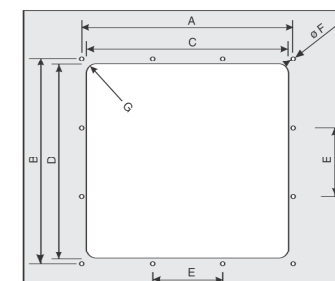
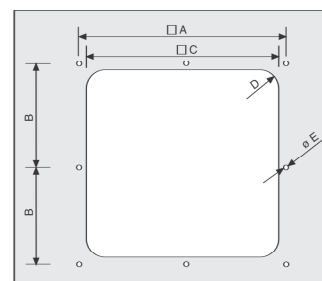
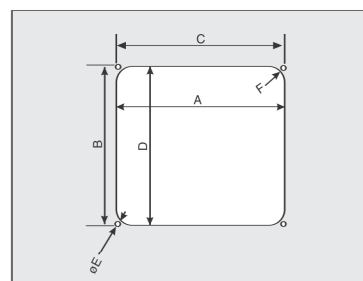
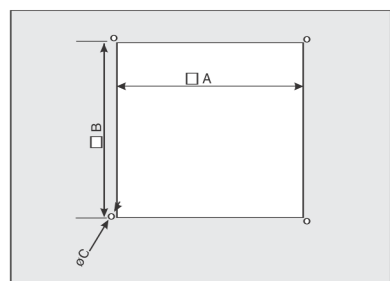
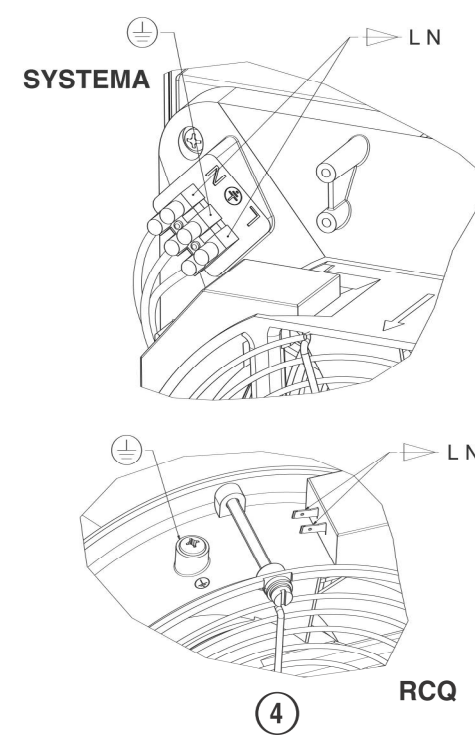
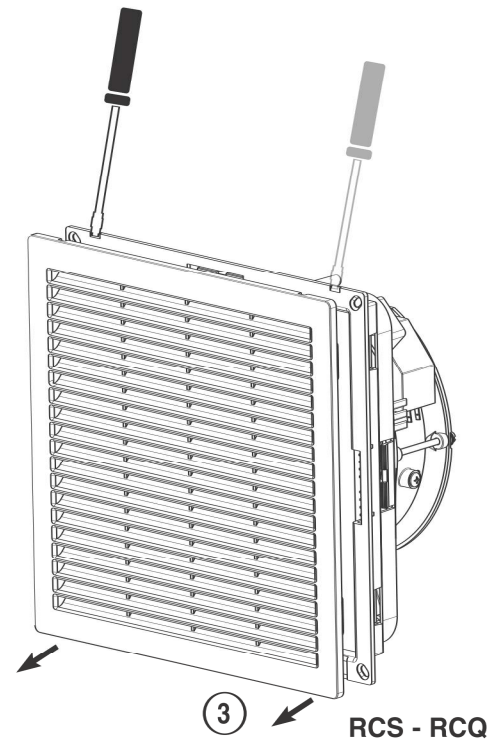
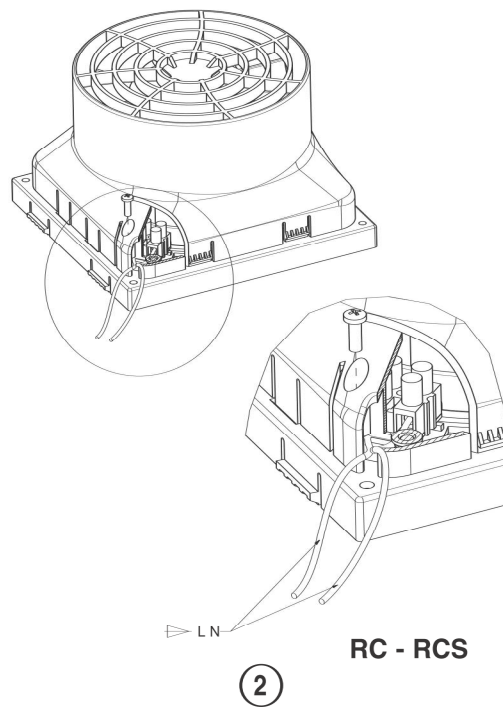
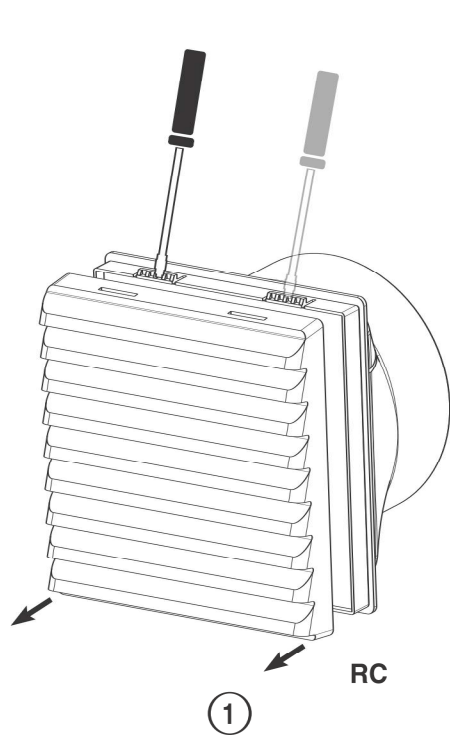

Model	A	B	ø C
<b>RCQ 50.11</b>	92	95	2,6
<b>RC 12.15 S / RCQ 160.15</b>	125	131	4,5
<b>RC 14.25 S / RCQ XXX.25</b>	223	230 ÷ 234	4,5
<b>RC 20.32 S</b>	291	302	4,5

RC 10.13 - RC 12.13 - G 13					
A	B	C	D	E (ø)	F (r)
117	123	115	125	3	12

RC 14.25 - G 25				
A	B	C	D (r)	E (ø)
232	116	220	15	3,5

RC 14.32 - RC 15.32 - RC 20.32 - G 32						
A	B	C	D	E	F (ø)	G (r)
302	297	287	281	100	3,5	12,5