

ASPIRATORE CENTRIFUGO – CENTRIFUGAL FAN

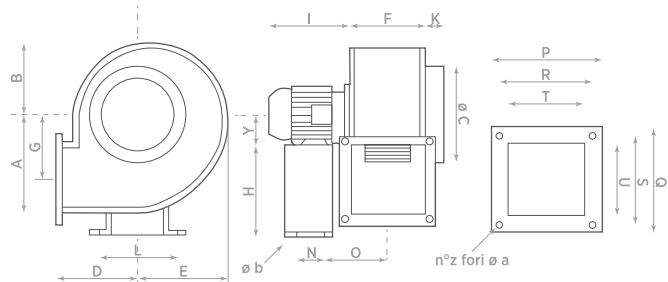

MODELLO MODEL	A	B	ØC	D	E	F	G	H	Y	K	I	L	N	O	P	Q	R	S	T	U	Z	Øa	Øb
CS 310	139	108	180	127	122	94	91	-	63	42	190	-	-	-	135	135	114	114	88	90	4	8,2	-
CS 320	172	128	200	146	150	112	117	-	63	45	190	-	-	-	152	152	126	126	105	105	4	8,2	-
CS 330	209	163	250	147	188	141	139	-	71	40	210	-	-	-	191	191	165	165	134	134	4	8,2	-
CS 340	250	194	250	178	222	164	162	-	80	45	240	-	-	-	225	235	195	205	161	170	4	8,2	-
CS 350	290	225	315	210	260	194	192	245	80	50	240	232	120	149	255	255	225	225	191	194	4	8,2	11
CS 360	290	225	315	210	260	194	192	245	90	50	255	232	120	155	255	255	225	225	191	194	4	8,2	11
CS 370	334	244	355	230	250	221	210	350	100	50	315	325	170	173	284	305	254	275	313	244	4	10,2	11
CS 380	429	315	400	300	370	249	280	350	112	62	330	325	170	194	310	360	280	330	241	295	8	9	11



Aspiratori centrifughi per l'espulsione in condotto di grossi volumi di aria non polverosa.

- Applicabile su macchinari dove sia necessaria ventilazione o aspirazione forzata;
- Bassa rumorosità in rapporto alle elevate prestazioni;
- Temperatura max aria aspirata: 50°C;
- Corpo in lamiera di acciaio verniciato a forno con polveri epossidiche anticorrosione;
- Ventola in lamiera di acciaio;
- Prodotto standard con colcea in posizione CCW 270
- Su richiesta fornito con posizioni coclea e senso di rotazione diversi (vedi tabella a pag. 78);
- Motore su cuscinetti a sfera per una lunga durata;
- Grado di protezione motore IP55;
- Regolabili mediante i regolatori industriali (opzionali);
- A partire dal modello 350, i prodotti sono dotati di supporto rigido (sedia) per facilitarne l'installazione;
- Conforme ai requisiti essenziali della dir. 2006/42/CE relativa alle macchine ed alle NORME UNI EN ISO 13857 e 12499; CEI EN 60204 - 1.
- **POSIZIONAMENTO:** a Parete

Centrifugal silenced duct fans to extract large air volumes and non dusty fumes.

- Suitable for application on machines where a forced ventilation or air suction is required;
- Max temperature of extracted air: 50°C;
- Low sound level and high performances;
- Steel plated frame protected by an epoxy-based anticorrosive paint and aluminium centrifugal impeller statically and dynamically balanced;
- Ball bearing class F insulation motor IP55 protected;
- Standard product supplied with impeller housing position CCW 270, different positions available on request, (see table on page 78);
- Motor speed can be regulated through industrial controllers (see accessories);
- In accordance with the essential requirements of 2006/42/EC Directive concerning machines and European Standards UNI EN ISO 13857; UNI EN ISO 12499; CEI EN 60204-1;
- Models CS 350, 360, 370 and 380: mounted on rigid base support to make installation easier.
- **POSITIONING:** Wall mounting

DATI TECNICI – TECHNICAL DATA

MODELLO MODEL	CODICE CODE	MOTORE MOTOR	N° POLI N° POLES	GIRI AL MINUTO REV. PER MIN. (RPM)	TENSIONE VOLTAGE (Volt)	FREQUENZA FREQUENCY (Hz)	PORTATA FLOW RATE m³/h	PRESS. MAX MAX PRESS. (mm H ₂ O)	PRESS. MAX MAX PRESS. (Pa)	POTENZA POWER (W)	CORR. NOM. (A) NOM. CURR. 230 V 400 V	GRADO IP PROTECTION	RUMOROSITÀ NOISINESS dB(A) _{1m}	PESO WEIGHT (Kg)	
CS 310 4M	0042000	single p.	4	1400	230	50	500	16	155	110	0,72	-	IP55	64	8
CS 320 4M	0042200	single p.	4	1400	230	50	800	20	200	130	0,78	-	IP55	67	9
CS 310 4T	0042100	three p.	4	1400	230/400	50	500	16	155	110	0,7	0,4	IP55	64	8
CS 320 4T	0042300	three p.	4	1400	230/400	50	800	20	200	130	0,74	0,43	IP55	67	9
CS 330 4T	0042400	three p.	4	1400	230/400	50	1500	36	360	300	1,2	0,7	IP55	70	11
CS 340 4T	0042500	three p.	4	1400	230/400	50	2900	46	450	800	2,8	1,6	IP55	73	21
CS 350 4T	0042600	three p.	4	1400	230/400	50	4100	44	430	1300	4,0	2,3	IP55	76	24
CS 360 4T	0042700	three p.	4	1400	230/400	50	5200	64	630	1800	6,0	3,5	IP55	80	27
CS 370 4T	0042800	three p.	4	1400	230/400	50	6000	66	650	2600	8,7	5,0	IP55	84	42
CS 380 4T	0042900	three p.	4	1430	230/400	50	9500	97	950	4500	15	9,0	IP55	88	63

AMBITI APPLICATIVI

Indicatore per installazione in ambito commerciale, terziario e industriale:

- Cucine e mense;
- Negozi;
- Uffici;
- Officine;
- Impianti sportivi;
- Supermercati e centri commerciali;
- Depositi e magazzini;
- Industrie;
- Macchinari.

ENVIRONMENTS APPLICATION

Suitable for installation in Commercial, industrial and tertiary environment:

- Kitchen and Canteens;
- Shops;
- Offices;
- Workshops;
- Sports facilities;
- Supermarkets and Shopping Centers;
- Warehouses;
- Factories;
- Machinery.

GRAFICI DI PORTATA - FLOW CHARTS

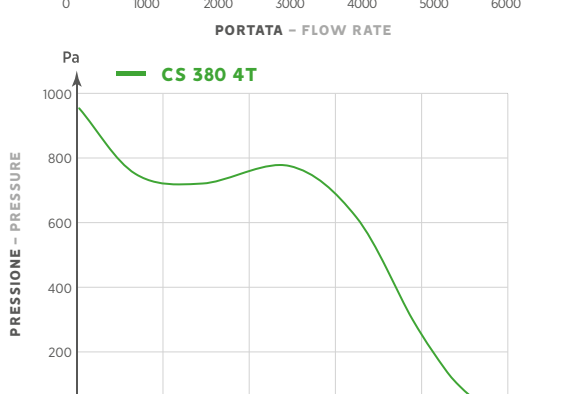
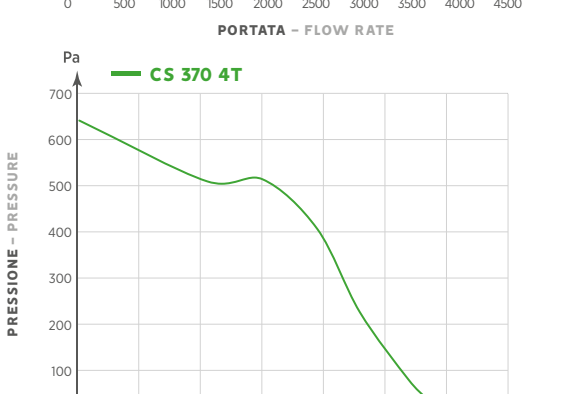
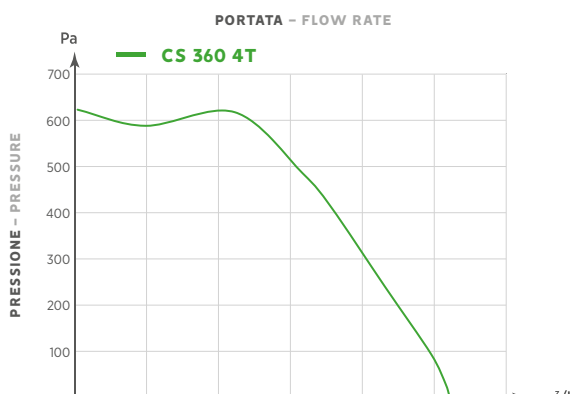
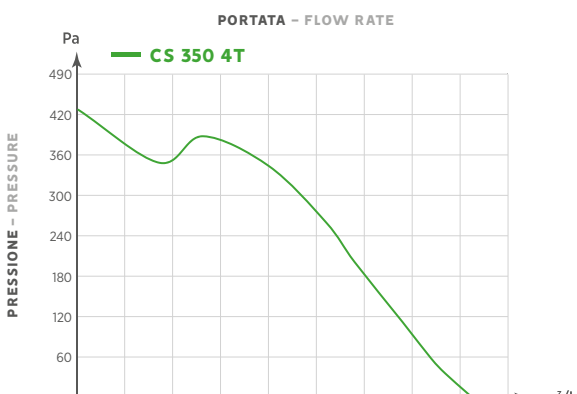
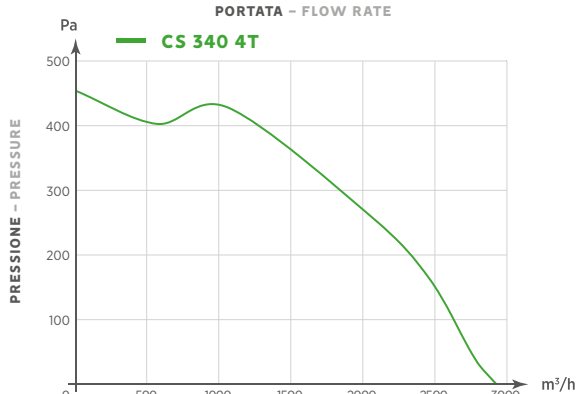
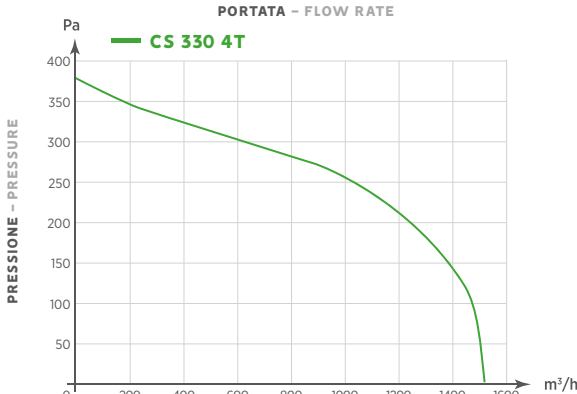
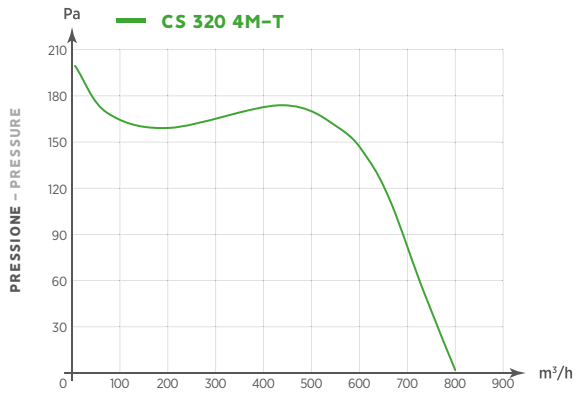
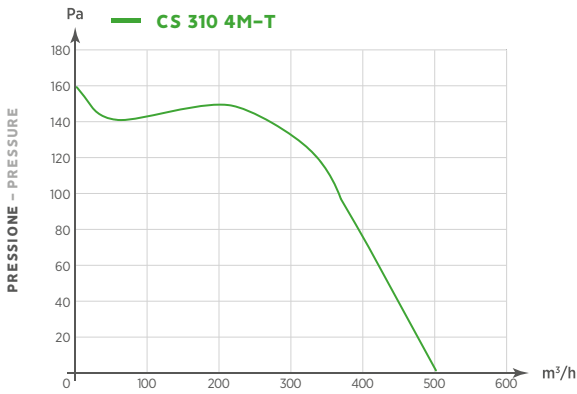

ACCESSORI (PAGINA 74) - ACCESSORIES (PAGE 74)



Regolatori
Controllers